

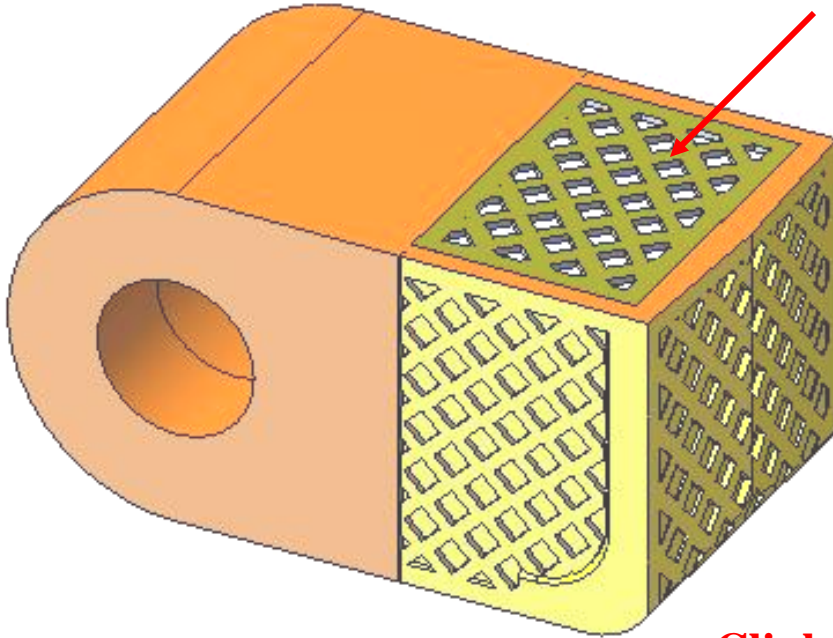

**IMCO make Clinker
crusher hammer fitted with
Zuper Block Composite
Sintered Carbide**

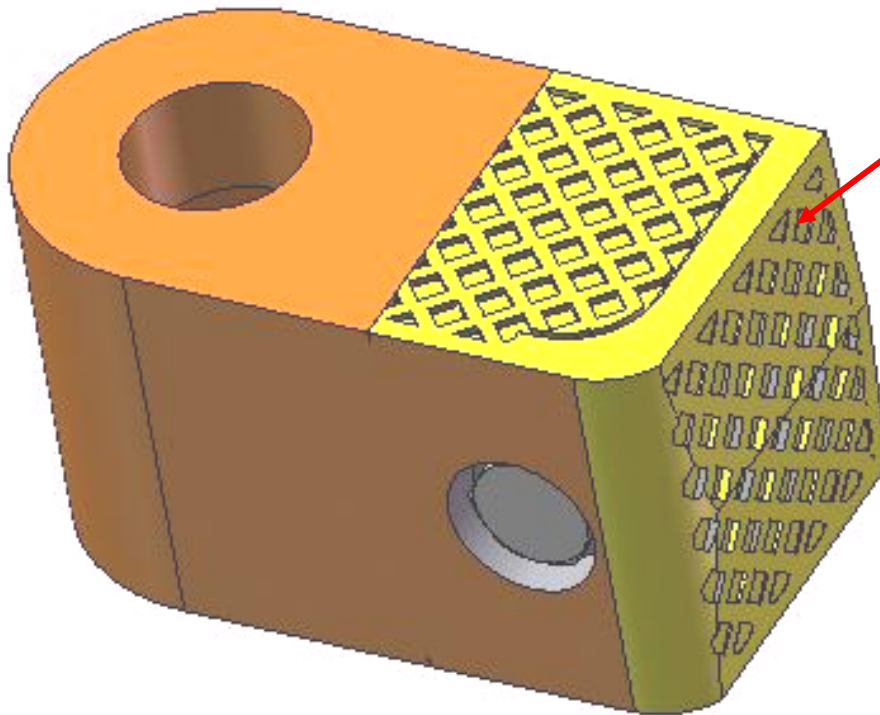

**Clinker crusher hammer
duly protected Composite
Sintered Carbides**





Assembly of IMCO make Clinker crusher hammer fitted with Zuper Block Sintered Composite Carbide



Fig. 1 & 2 – Assembly of Clinker Crusher Hammer with Zuper Block Sintered Composite Carbide



Fig. 3 & 4 - Zuper Block composite sintered carbide assembled with Clinker Crusher Hammer & tighten the bolt with Torque Wrench.



Fig. 5 – Bottom & Top view of Clinker Crusher Hammer with Zuper Block composite sintered carbide



Fig.6 – After assembly and painting Clinker Crushers Hammer with Zuper Block composite sintered carbide are ready for dispatch.